

(16.46)

Sonia Avenue

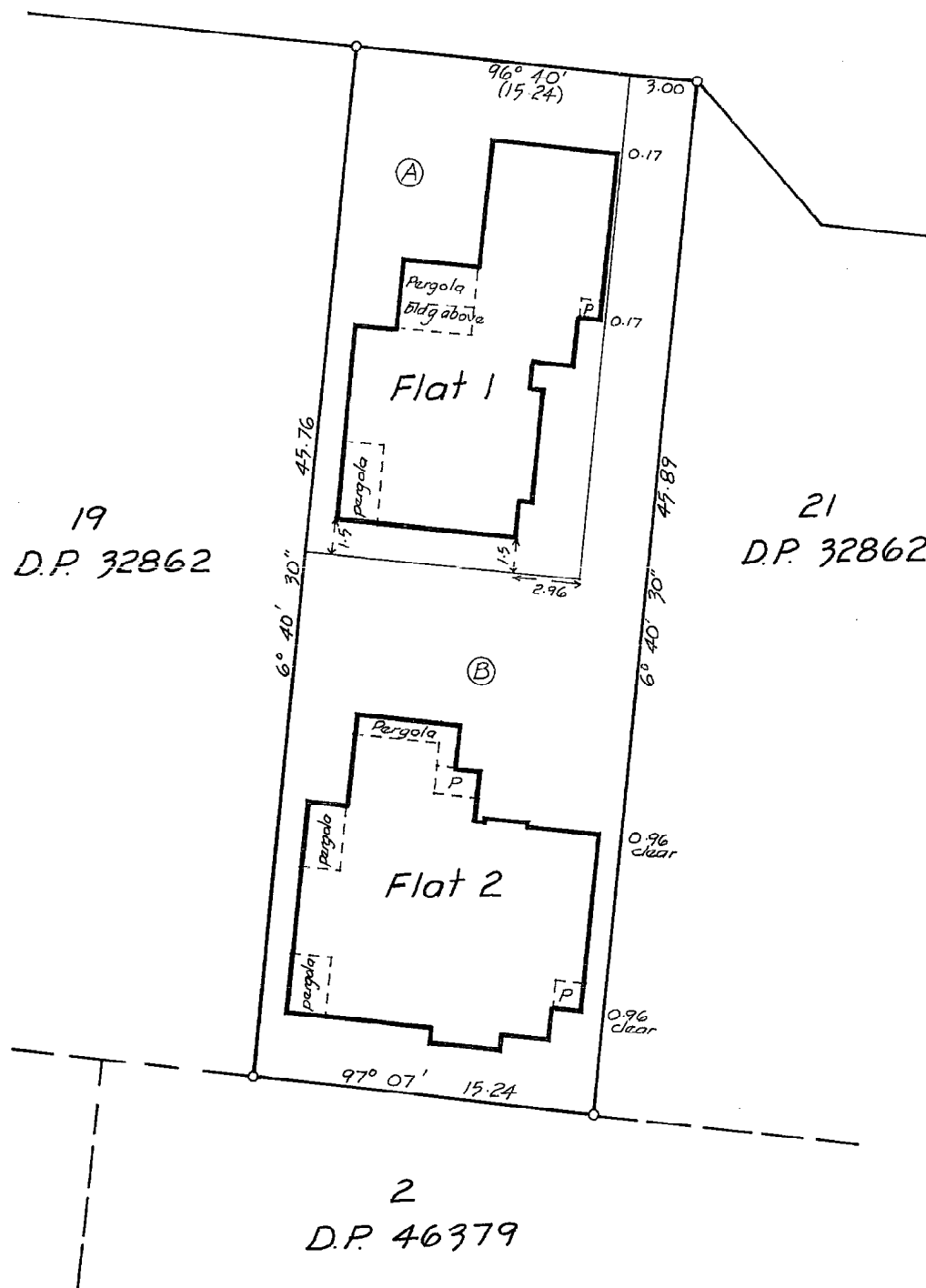
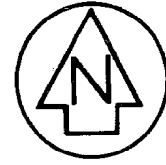

Approvals *V. Bottle*
Sam Gollie
S. G. Bottle
 Registered Owners

Areas shown (A) & (B) to be subject to restrictive covenants. Restrictive Covenant boundaries are not visibly defined unless otherwise shown. Road shown is legal.

Boundaries of areas to be leased are along the external face of exterior walls, structures and roofs unless otherwise shown.

S = steps P = porch L = landing

New C T Allocated
 Flat 1 90B/263
 Flat 2 90B/264

I, Robert Glen Ogilvie of Auckland registered surveyor and holder of an annual practising certificate hereby certify that the buildings shown hereon are erected in the position shown and are situated within the boundaries of CT 877/278 and that the plan is correct.

Dated this 2nd day of May 1992
[Signature] Signature

Total Area 698 m²

Comprised in C.T. 877/278 (All)

I, Registered Surveyor and holder of an annual practising certificate (or who may act as a registered surveyor pursuant to section 25 of the Survey Act 1986) hereby certify that this plan has been made from surveys executed by me or under my directions, that both plan and survey are correct and have been made in accordance with the Survey Regulations 1972 or any regulations made in substitution thereof.

Dated at this day of 19..... Signature

Field Book p. Traverse Book p. Reference Plans

Examined *Monique Ross* Correct *Robert Gollie*

Approved as to Survey For the purpose of Leasing flats only *[Signature]* 25/ 5 / '92 DEPUTY Chief Surveyor

Deposited this 14th day of June 1992 For the purpose of Leasing flats only *[Signature]* District Land Registrar

File Received 11 MAY 1992 Instructions DP 151489

LAND DISTRICT North Auckland SURVEY BLK. & DIST. VII Rangitoto NZMS 261 SHT RECORD MAP No Auck 46

PLAN OF FLATS ON LOT 20 D.P. 32862

TERRITORIAL AUTHORITY Auckland City Surveyed by R.G. Ogilvie & Assoc. Scale 1:200 Date May 1992

W.N. HAWKEY, SURVEYOR GENERAL, DEPARTMENT OF LANDS AND SURVEY NEW ZEALAND WELLINGTON

Printed by Sterling Imports Ltd. Auckland, New Zealand.

L & S FORM N93

